

Notes:

- 1) Partition walls shown without shading will be installed after floor installation and will not provide bearing to joists.
- 2) RimBoard - Use Timberstrand LSL 1.55E 1-3/4" x 11-7/8"
- 3) Use Simpson Strong-Tie HUS412 hanger where beams frame into the sides of supporting members.
- 4) Provide ICFVL Fastener directly below post and at 32" o.c. max from post location Typical where post does not have full bearing on concrete.
- 5) Provide Full Bearing for W8x18 on Post at Both Ends. Hang BB4 on side of P6 using Simpson HUS410 Beam Hanger

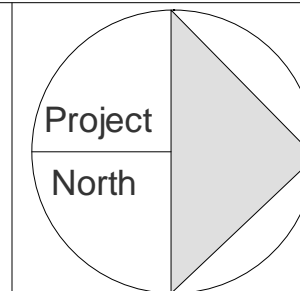

No.	Date	Issue
A	September 22, 2013	For Comment
B	November 20, 2013	For Comment/Markup
C	November 21, 2013	For Comment/Markup
1	March 24, 2014	For Building Permit App.

#	Size	Notes	Length
BL1	3-1/2" x 5-1/4" PSL 1.8E	2 Jack 1 King 2x6 Studs Each End	3' 9"
BL2	3-1/2" x 5-1/4" PSL 1.8E	2 Jack 1 King 2x6 Studs Each End	3' 9"
BL3	3-1/2" x 5-1/4" PSL 1.8E	2 Jack 1 King 2x6 Studs Each End	3' 9"

#	Size (PSL 2.0E Flush U.N.O.)	Length
BB1	3-1/2" x 11-7/8" PSL	8' 4-3/8"
BB2	W8x18 Steel	8' 9"
BB3	3-1/2" x 11-7/8" PSL	6' 9-3/4"
BB4	3-1/2" x 9-1/4" PSL Dropped	7' 4"
BB5A	3-1/2" x 9-1/4" PSL Dropped	8' 7"
BB5B	3-1/2" x 11-7/8" PSL	9' 6"
BB6	3-1/2" x 9-1/4" PSL Dropped	10' 2-1/4"
BB7	3-1/2" x 11-7/8" PSL	10' 10-3/4"
BB8	3-1/2" x 11-7/8" PSL	10' 3"

#	Description
P1	3-Ply 2x6 S-P-F No. 2 Post
P2	4-Ply 2x6 S-P-F No. 2 Post
P3	HSS 3-1/2" x 3-1/2" x 1/4"
P4	3-Ply 2x4 S-P-F No. 2 Post
P5	4-Ply 2x4 S-P-F No. 2 Post
P6	5-Ply 2x6 S-P-F No. 2 Post

Type	Framing Members
W1	2x6 Wood Studs @ 16" O.C.
W2	2x4 Wood Studs @ 16" O.C.

#	Description
H1	All OJ314 & OJ315 Floor Truss to use Simpson Strong-Tie Truss Hanger LT251188
H2	All OJ415 & OJ418 Floor Truss to use Simpson Strong-Tie Truss Hanger LT351188
H3	Rim Board Fastening to Foundation - Simpson Strong-Tie Ledger Hanger ICFV-CW @ 32" O.C.

#	Size	Notes
CL1	6-1/2" Wide x 12" Deep Min.	2 - 15M Bars extended 24" Beyond opening. 1-1/2" Clear Bottom and Side Cover, 10M Stirrups @ 6" o.c.
CL2	6-1/2" Wide x 12" Deep Min.	2 - 15M Bars extended 24" Beyond opening. 1-1/2" Clear Bottom and Side Cover

Type	Unfactored Loads	
	Dead	Live
UDL1	0.5 kN/m	1.8 kN/m

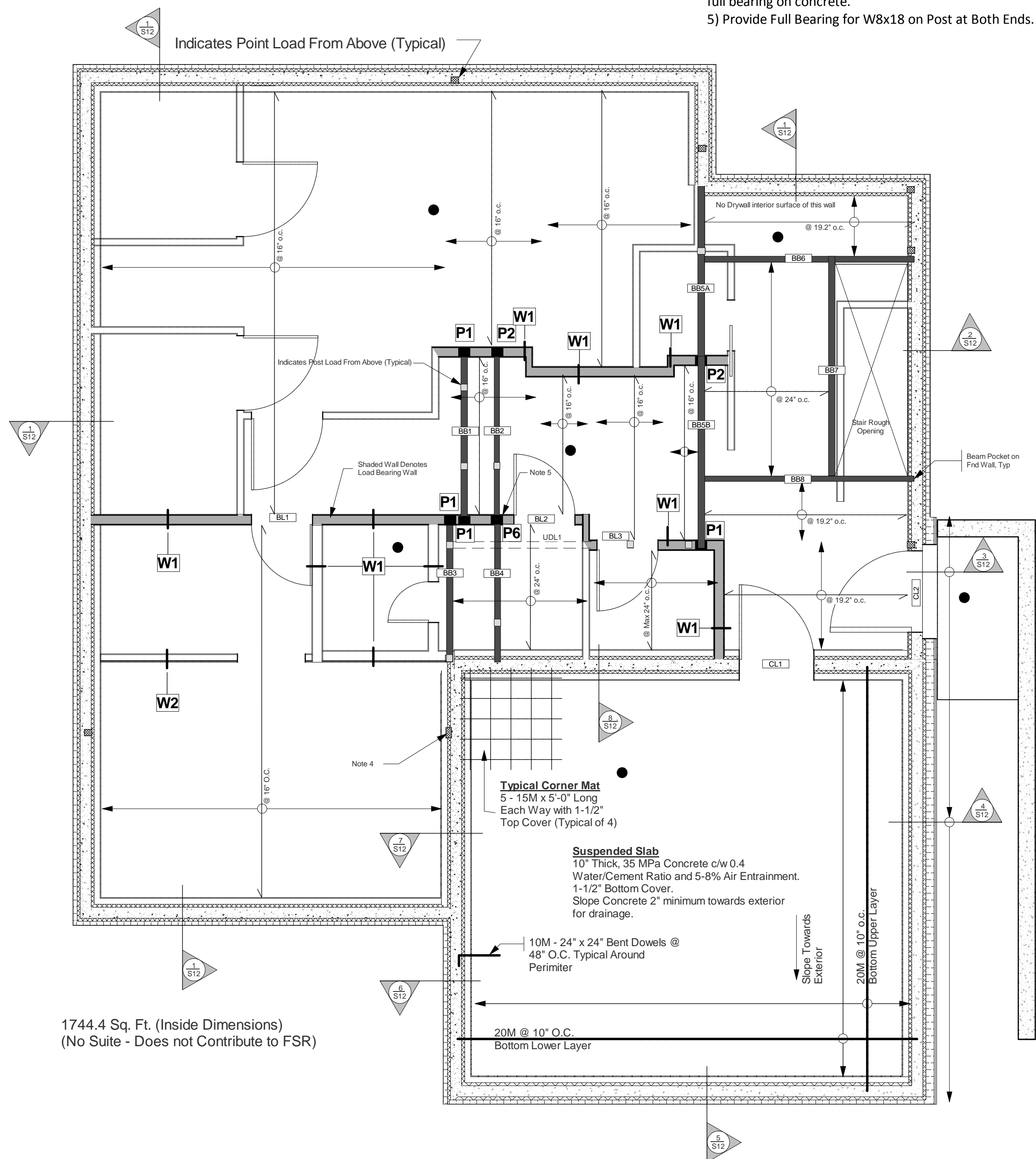

1744.4 Sq. Ft. (Inside Dimensions)
(No Suite - Does not Contribute to FSR)

Legend

- Point Load Above
- Post Below
-
- Floor Drains



718-333 Brooksbank Ave Room 237
North Vancouver, BC V7J 3V8
Tel: 778-688-5807

Project Title
The Enclosure
Pemberton Heights, North Vancouver - British Columbia

Drawing
Main Floor Framing Plan

Scale: 1/4" = 1'
Date: March 24, 2014
Drawn By: SW

Dwg. #
S2